

55590 Hondo St., 92284
Yucca Valley, Calif.
August 16, 1972

Dear Dick-

Re our phone call last night, I am enclosing information as per your request.

Leonard Tadlock and I paced the perimeter of the claim and 6 stakes were set. The location stake is always laying on the ground whenever I come up there with the location can in a pile of rocks underneath. The original location notice copy "yellow paper" is enclosed.

A guy by the name of ~~Fx~~ Styles promised to install the necessary post, etc. when I left there in June but have not heard from him. Result-I could not trust him on any deal.

The new location system should be finished by Sept. 1st but am sure Barton will extend that date for you if necessary.

And Doc states that he will operate on this here bum ankle any time. Will wait until you get thru the job for me.

Kind regards,

Sincerely,



Phone at any time you wish, COLLECT 714 - 364 - 2209

Best time - 6 - 7 P.M.

6-2-73

All work will be completed on the mine by 6-12-73.

~~Any injury or death incurred on the property to workmen~~
Roy Jewett, owner, will not be held responsible for any
liability due to injury or death to the workmen on the
mining site.

All of the actual mining work done with power machinery
and removal of rock will be done in a workman like
manner and in accordance with standard mining
practices.

Upon the discovery of a ^{valid} natural turquoise deposit
the sum of \$4000. shall be paid to Roy Jewett.

Rick Anderson
for
Tomo Enterprises

5.

6) YET ANOTHER LATTICE:

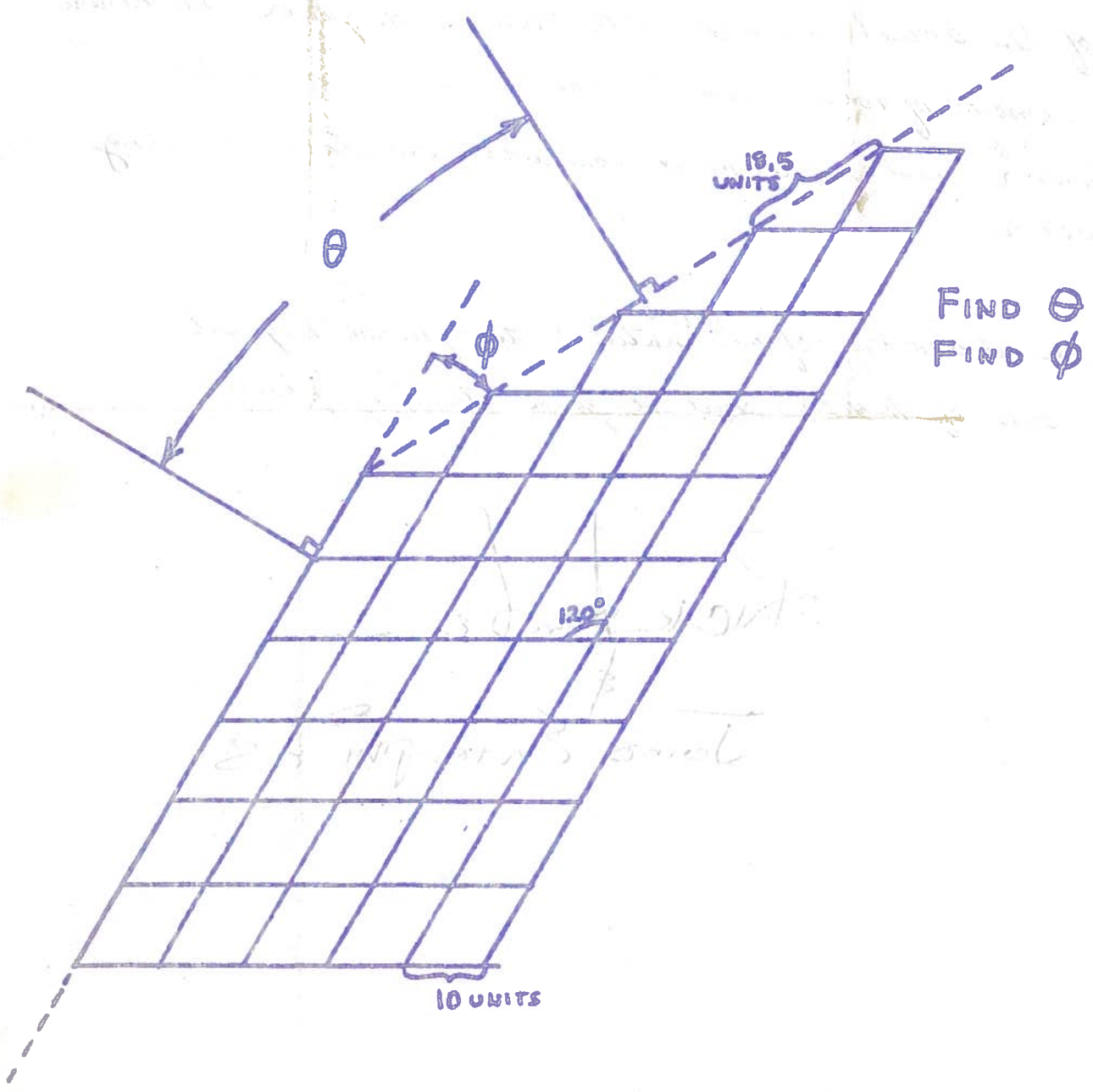

L. R. Jewett

Proof of Performance and Completion of ANNUAL ASSESSMENT WORK

STATE OF Nevada }
County of Mineral } ss.

The undersigned, in whose behalf the following described work was performed or improvements made, certifies that at least \$150.00 Dollars was expended, and/or the following labor expended or improvements made having a value thereof, consisting of: Bulldozer, open cut -North Easterly and South Westerly direction from Location Post, open cut is 20 feet deep, 100 feet long, 12 feet wide

were performed and made upon Roy Lode Claim

(Insert Name(s) of Claims(s))

situated in the Miller Mountain Mining District of the County of Mineral, State of Nevada, during the year ending 12:00 Noon, September 1, 1972.

The work described above was performed on June 14th., 1972 (Insert Dates that Work was Performed)

by Richard Dick Horne (Insert Names of Persons, Corporation or Contractor who Performed the Work or made the Improvements)

Such expenditure was made by or at the expense of L.R.Jewett

owner(s) of said claim(s) for the purpose of holding said claim(s).

L.R. Jewett
(Signature of Person Certifying the Above)

Subscribed and sworn to before me this 16th. day of June, 1972

L.E. Cornelius
NOTARY PUBLIC July 7th., 1975
My Commission Expires OR

L.E. Cornelius
WITNESS
Notary Public — State of Nevada
Mineral County
My Commission Expires July 7, 1975
WITNESS

Recorder's Stamp

13266

BOOK 30 PAGE 961

L.R. JEWETT
72 JUN 16 AM 9:26

OFFICIAL RECORDS
MINERAL CO. NEV.
RECORDS REQUIRED BY

GARY L. BARTON
COUNTY RECORDER
FEE \$52.00
DEP.

Proof of Performance and Completion of Annual Assessment Work must be Recorded within 60 days after Completion of Work and must be Sworn to before a Notary Public or subscribed to by Two Competent Witnesses. (NBS 517.230)

Lake Tahoe?

Recd. from Rick Anderson of Palm Springs
Calif, a certified check for \$_____ for
payment on the purchase of the Roy Lode^{mineral}
Claim which is located about 3.8 miles
from the intersection of Hwy 6 & Hwy 10. Also
the claim is 1/8 mile east of Hwy 10. Above
location is in the Miller Mt. District, Mineral
County, Nevada.

Proof of Performance and completion
of Annual Assessment Work for the years
1972-1971 and 1970 are recorded in
the official records of Mineral County,
at Hawthorne, Nevada.

1972 Recording #132,661

Book 30 - Page 961, - June 16th

by R.R. Jewett

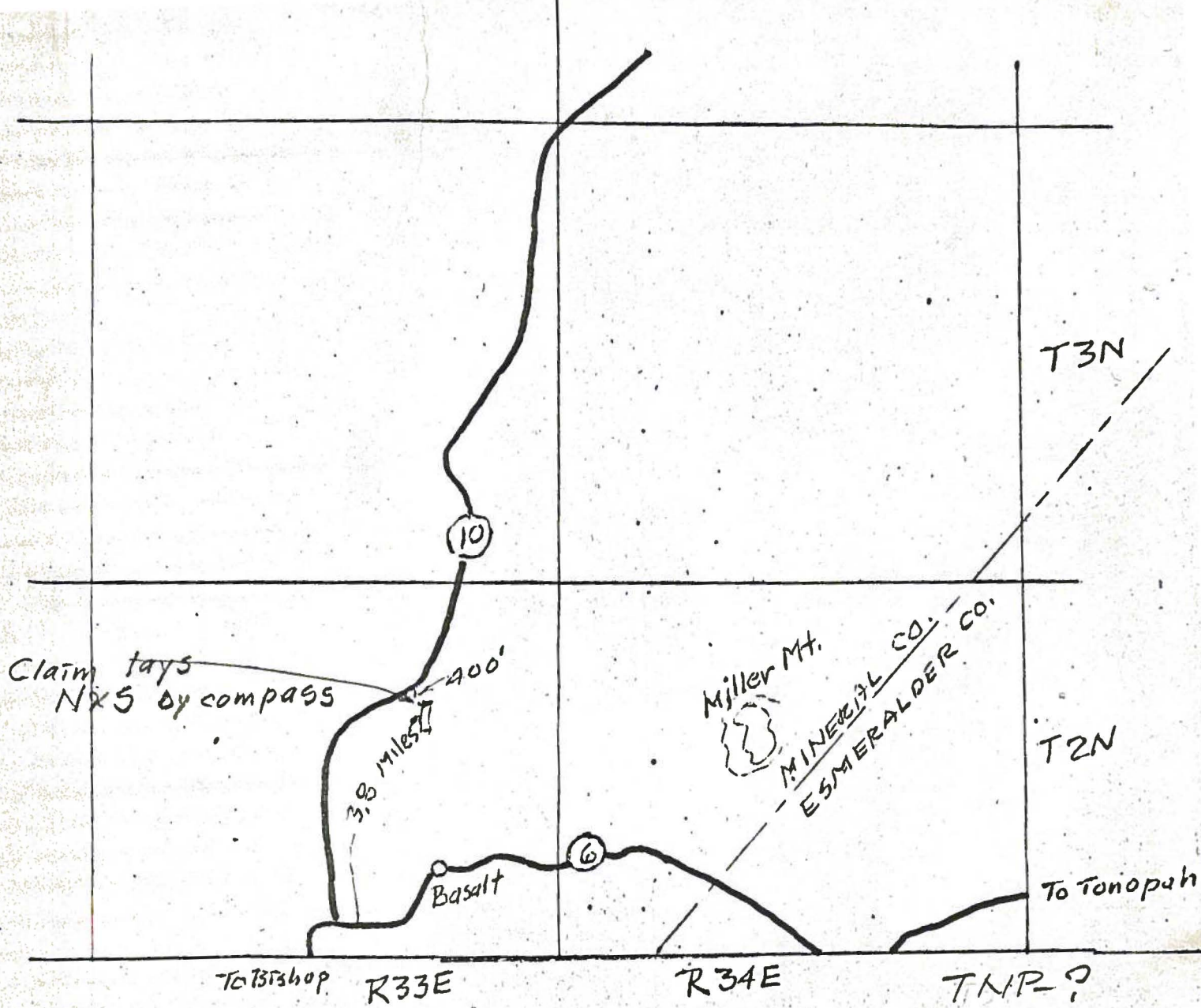

ROY LOAD CLAIM
 L. R. Jewett

ARMY MAP SERVICE-NEV.
 91261